

Bramac Sicherheitsdachhaken

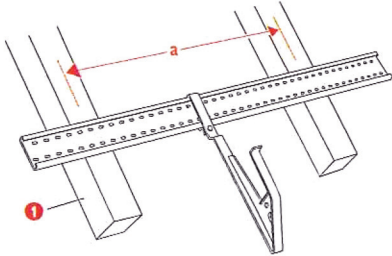

- 1 min. 80 x 100 mm
 - a max. 1000 mm
 - 2 50 x 30 mm
 - 3 50 x 50 mm
 - 4 24 mm
- A

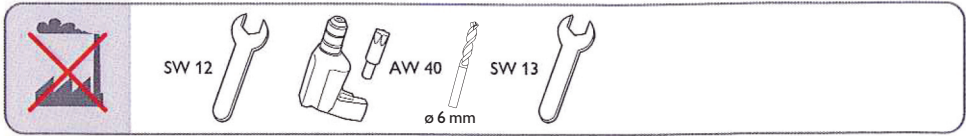
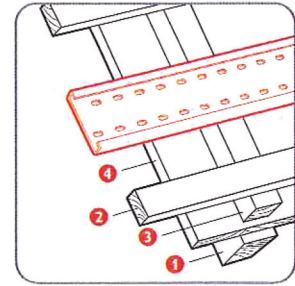

- 1 min. 80 x 100 mm
 - a max. 1000 mm
 - 2 60 x 40 mm (d = 10 mm)
 - 3 50 x 50 mm
 - 4 24 mm
- B

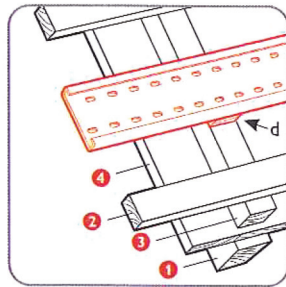

- 1 min. 80 x 140 mm
 - a max. 1000 mm
 - 2 50 x 30 mm (d = 0 mm)
 - 60 x 40 mm (d = 10 mm)
- C

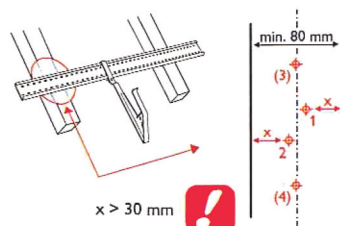
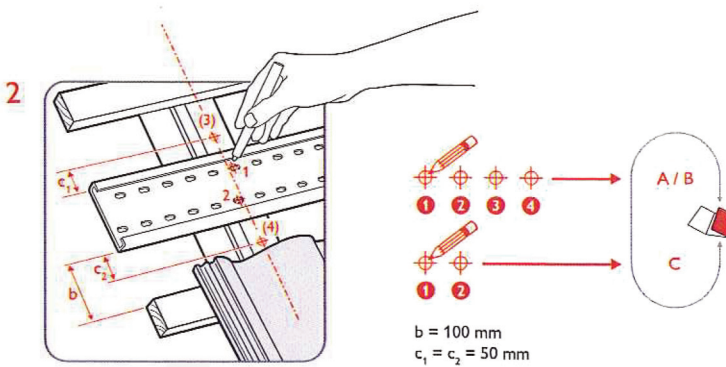
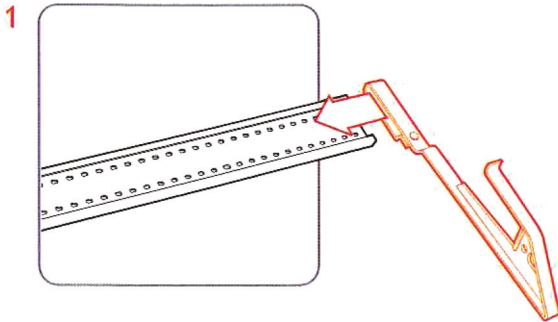
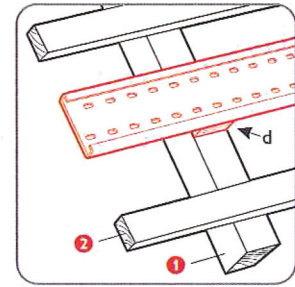

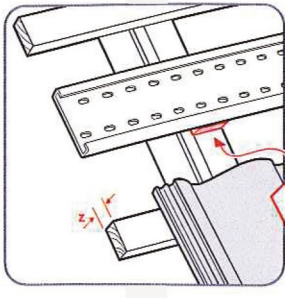

$z = 30 \text{ mm} \rightarrow d = 0 \text{ mm}$
 $z = 40 \text{ mm} \rightarrow d = 10 \text{ mm} = \text{Max.}$

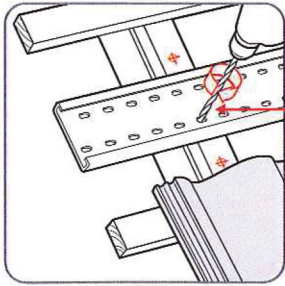

$\varnothing = 6 \text{ mm}$

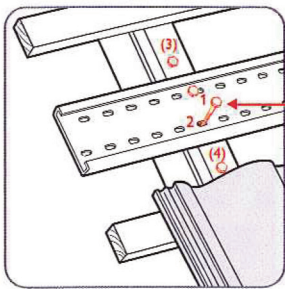

SW 12 / AW 40

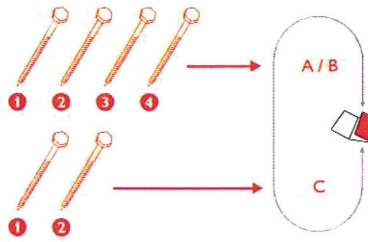

3

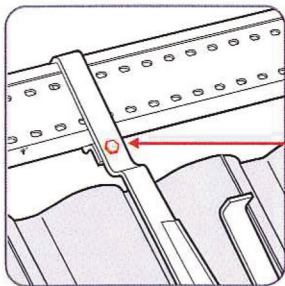

SW 13

4

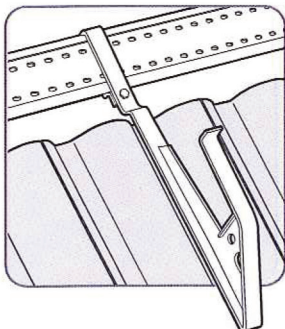



Hersteller-Verarbeitungsvorschriften
© Copyright BMI Austria GmbH,
Stand Mai 2021
Technische Änderungen vorbehalten
Satz- und Druckfehler vorbehalten
05/2021, Ersetzt Ausgabe 05/2019
Bei allen Abbildungen handelt es sich um Symbolfotos.

BMI Austria GmbH
Hauptverwaltung

Bramacstraße 9
A-3380 Pöchlarn
+43 27 57 4010-0
office.bramac@bmigroup.com

bmigroup.com/at